

ANSI B16.5 Class 150 Forged Flanges

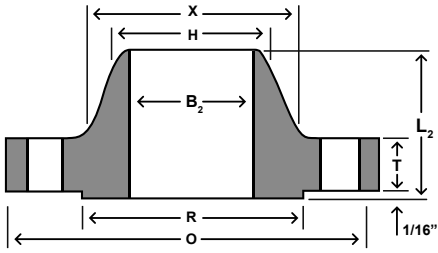

WELD NECK

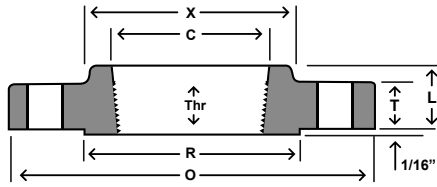

THREADED

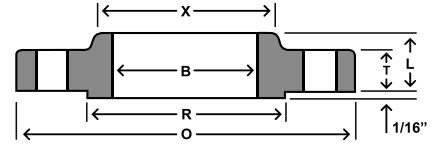

SLIP-ON

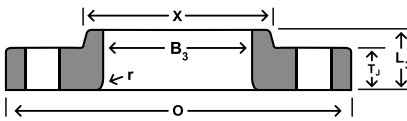

LAP JOINT

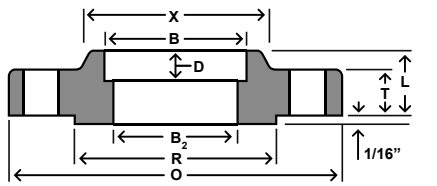

SOCKET WELD

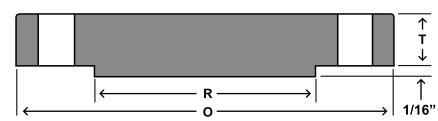

BLIND

Nom. Pipe Size	O	T	T _J	R	X	#/Dia of Holes ^a	Bolt Circle Dia	B	B ₂ ^b	B ₃	H	L	L ₂	L ₃ ^c	r	D	Thr
1/2	3.50	0.38	0.44	1.38	1.19	4-0.62	2.38	0.88	0.62	0.90	0.84	0.56	1.81	0.62	0.12	0.38	0.62
3/4	3.88	0.44	0.50	1.69	1.50	4-0.62	2.75	1.09	0.82	1.11	1.05	0.56	2.00	0.62	0.12	0.44	0.62
1	4.25	0.50	0.56	2.00	1.94	4-0.62	3.12	1.36	1.05	1.38	1.32	0.62	2.12	0.69	0.12	0.50	0.69
1 1/4	4.62	0.56	0.62	2.50	2.31	4-0.62	3.50	1.70	1.38	1.72	1.66	0.75	2.19	0.81	0.19	0.56	0.81
1 1/2	5.00	0.62	0.69	2.88	2.56	4-0.62	3.88	1.95	1.61	1.97	1.90	0.81	2.38	0.88	0.25	0.62	0.88
2	6.00	0.69	0.75	3.62	3.06	4-0.75	4.75	2.44	2.07	2.46	2.38	0.94	2.44	1.00	0.31	0.69	1.00
2 1/2	7.00	0.81	0.88	4.12	3.56	4-0.75	5.50	2.94	2.47	2.97	2.88	1.06	2.69	1.12	0.31	0.75	1.12
3	7.50	0.88	0.94	5.00	4.25	4-0.75	6.00	3.57	3.07	3.60	3.50	1.12	2.69	1.19	0.38	0.81	1.19
3 1/2	8.50	0.88	0.94	5.50	4.81	8-0.75	7.00	4.07	3.55	4.10	4.00	1.19	2.75	1.25	0.38	0.88	1.25
4	9.00	0.88	0.94	6.19	5.31	8-0.75	7.50	4.57	4.03	4.60	4.50	1.25	2.94	1.31	0.44	0.94	1.31
5	10.00	0.88	0.94	7.31	6.44	8-0.88	8.50	5.66	5.05	5.69	5.56	1.38	3.44	1.44	0.44	0.94	1.44
6	11.00	0.94	1.00	8.50	7.56	8-0.88	9.50	6.72	6.07	6.75	6.63	1.50	3.44	1.56	0.50	1.06	1.56
8	13.50	1.06	1.12	10.62	9.69	8-0.88	11.75	8.72	7.98	8.75	8.63	1.69	3.94	1.75	0.50	1.25	1.75
10	16.00	1.12	1.19	12.75	12.00	12-1.00	14.25	10.88	10.02	10.92	10.75	1.88	3.94	1.94	0.50	1.31	1.94
12	19.00	1.19	1.25	15.00	14.38	12-1.00	17.00	12.88	12.00	12.92	12.75	2.12	4.44	2.19	0.50	1.56	2.19
14	21.00	1.31	1.38	16.25	15.75	12-1.12	18.75	14.14	13.25	14.18	14.00	2.19	4.94	3.12	0.50	1.63	2.25
16	23.50	1.38	1.44	18.50	18.00	16-1.12	21.25	16.16	15.25	16.19	16.00	2.44	4.94	3.44	0.50	1.75	2.50
18	25.00	1.50	1.56	21.00	19.88	16-1.25	22.75	18.18	17.25	18.20	18.00	2.62	5.44	3.81	0.50	1.94	2.69
20	27.50	1.62	1.69	23.00	22.00	20-1.25	25.00	20.20	19.25	20.25	20.00	2.81	5.62	4.06	0.50	2.13	2.88
22	29.50	1.75	1.81	25.25	24.25	20-1.38	27.25	22.22	21.25	22.25	22.00	3.07	5.82	4.25	0.50	2.38	3.13
24	32.00	1.81	1.88	27.25	26.12	20-1.38	29.50	24.25	23.25	24.25	24.00	3.19	5.94	4.38	0.50	2.50	3.25

DIMENSIONS ARE IN INCHES

(A) Bolt hole diameter 1/8" larger than bolt diameter

(B) Standard bore dimensions provided. See bore chart for other wall thicknesses

(C) This dimension is commonly associated with "true" lap joints. Industry standard is to make to the slip on length through the hub.

ANSI B16.5 Class 300 Forged Flanges

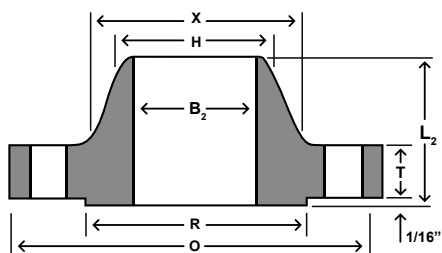

WELD NECK

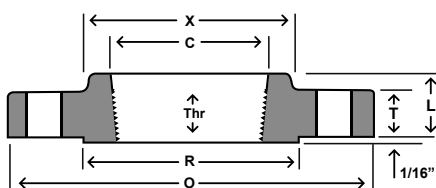

THREADED

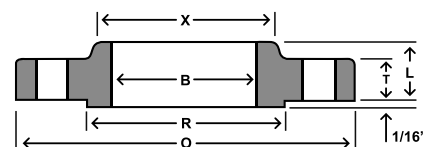

SLIP-ON

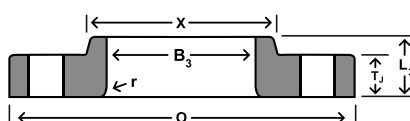

LAP JOINT

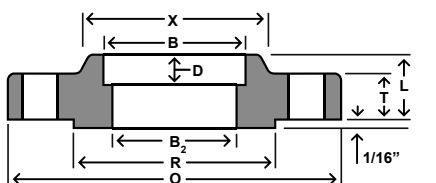

SOCKET WELD

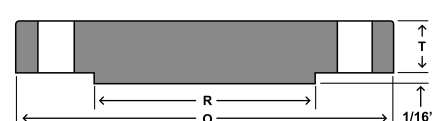

BLIND

Nom. Pipe Size	O	T	T ₂	R	X	#/Dia of Holes ^a	Bolt Circle Dia	B	B ₂ ^b	B ₃	H	L	L ₂	L ₃ ^c	r	C	D	Thr
1/2	3.75	0.50	0.56	1.38	1.50	4-0.63	2.62	0.88	0.62	0.90	0.84	0.81	2.00	0.88	0.12	0.93	0.38	0.62
3/4	4.62	0.56	0.62	1.69	1.88	4-0.75	3.25	1.09	0.82	1.11	1.05	0.94	2.19	1.00	0.12	1.14	0.44	0.62
1	4.88	0.62	0.69	2.00	2.12	4-0.75	3.50	1.36	1.05	1.38	1.32	1.00	2.38	1.06	0.12	1.41	0.50	0.69
1 1/4	5.25	0.69	0.75	2.50	2.50	4-0.75	3.88	1.70	1.38	1.72	1.66	1.00	2.50	1.06	0.19	1.75	0.56	0.81
1 1/2	6.12	0.75	0.81	2.88	2.75	4-0.88	4.50	1.95	1.61	1.97	1.90	1.13	2.63	1.19	0.25	1.98	0.62	0.88
2	6.50	0.81	0.88	3.62	3.31	8-0.75	5.00	2.44	2.07	2.46	2.38	1.25	2.69	1.31	0.31	2.50	0.69	1.12
2 1/2	7.50	0.94	1.00	4.12	3.94	8-0.88	5.88	2.94	2.47	2.97	2.88	1.44	2.94	1.50	0.31	3.00	0.75	1.25
3	8.25	1.06	1.12	5.00	4.62	8-0.88	6.62	3.57	3.07	3.60	3.50	1.63	3.06	1.69	0.38	3.63	0.81	1.25
3 1/2	9.00	1.12	1.19	5.50	5.25	8-0.88	7.25	4.07	3.55	4.10	4.00	1.69	3.13	1.75	0.38	4.13	...	1.44
4	10.00	1.19	1.25	6.19	5.75	8-0.88	7.88	4.57	4.03	4.60	4.50	1.82	3.32	1.88	0.44	4.63	...	1.44
5	11.00	1.31	1.38	7.31	7.00	8-0.88	9.25	5.66	5.05	5.69	5.56	1.94	3.82	2.00	0.44	5.69	...	1.69
6	12.50	1.38	1.44	8.50	8.12	12-0.88	10.62	6.72	6.07	6.75	6.63	2.00	3.82	2.06	0.50	6.75	...	1.81
8	15.00	1.56	1.62	10.62	10.25	12-1.00	13.00	8.72	7.98	8.75	8.63	2.38	4.32	2.44	0.50	8.75	...	2.00
10	17.50	1.81	1.88	12.75	12.62	16-1.12	15.25	10.88	10.02	10.92	10.75	2.56	4.56	3.75	0.50	10.88	...	2.19
12	20.50	1.94	2.00	15.00	14.75	16-1.25	17.75	12.88	12.00	12.92	12.75	2.82	5.06	4.00	0.50	12.94	...	2.38
14	23.00	2.06	2.12	16.25	16.75	20-1.25	20.25	14.14	13.25	14.18	14.00	2.94	5.56	4.38	0.50	14.19	...	2.50
16	25.50	2.19	2.25	18.50	19.00	20-1.38	22.50	16.16	15.25	16.19	16.00	3.19	5.69	4.75	0.50	16.19	...	2.69
18	28.00	2.31	2.38	21.00	21.00	24-1.38	24.75	18.18	17.25	18.20	18.00	3.44	6.19	5.12	0.50	18.19	...	2.75
20	30.50	2.44	2.50	23.00	23.12	24-1.38	27.00	20.20	19.25	20.25	20.00	3.69	6.32	5.50	0.50	20.19	...	2.88
22	33.00	2.57	2.63	25.25	25.25	24-1.63	29.25	22.22	21.25	22.25	22.00	3.93	6.43	5.75	0.50	22.19	...	3.13
24	36.00	2.69	2.75	27.25	27.62	24-1.63	32.00	24.25	23.25	24.25	24.00	4.13	6.56	6.00	0.50	24.19	...	3.25

DIMENSIONS ARE IN INCHES

(A) Bolt hole diameter 1/8" larger than bolt diameter

(B) Standard bore dimensions provided. See bore chart for other wall thicknesses

(C) This dimension is commonly associated with "true" lap joints. Industry standard is to make to the slip on length through the hub.

ANSI B16.5 Class 400 Forged Flanges

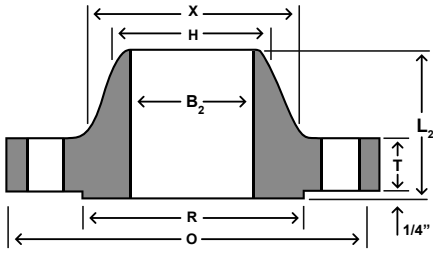

WELD NECK

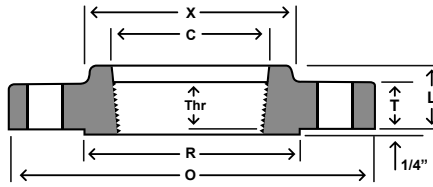

THREADED

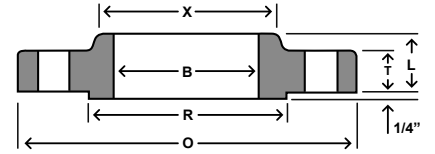

SLIP-ON

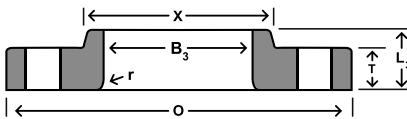

LAP JOINT

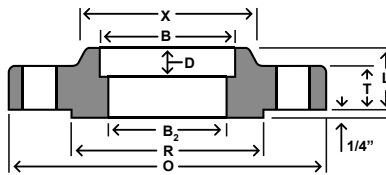

SOCKET WELD

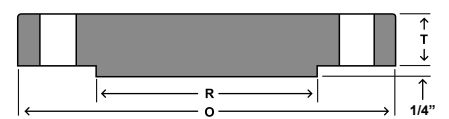

BLIND

Nom. Pipe Size	O	T	R	X	#/Dia of Holes ^a	Bolt Circle Dia	B	B ₂ ^b	B ₃	H	L	L ₂	L ₃ ^c	r	C	D	Thr
1/2	3.75	0.56	1.38	1.50	4-0.63	2.62	0.88		0.90	0.84	0.88	2.06	0.88	0.12	0.93	0.38	0.62
3/4	4.62	0.62	1.69	1.88	4-0.75	3.25	1.09		1.11	1.05	1.00	2.25	1.00	0.12	1.14	0.44	0.62
1	4.88	0.69	2.00	2.12	4-0.75	3.50	1.36		1.38	1.32	1.06	2.44	1.06	0.12	1.41	0.50	0.69
1 1/4	5.25	0.81	2.50	2.50	4-0.75	3.88	1.70		1.72	1.66	1.12	2.62	1.12	0.19	1.75	0.56	0.81
1 1/2	6.12	0.88	2.88	2.75	4-0.88	4.50	1.95		1.97	1.90	1.25	2.75	1.25	0.25	1.99	0.62	0.88
2	6.50	1.00	3.62	3.31	8-0.75	5.00	2.44		2.46	2.38	1.44	2.88	1.44	0.31	2.50	0.69	1.12
2 1/2	7.50	1.12	4.12	3.94	8-0.88	5.88	2.94		2.97	2.88	1.62	3.12	1.62	0.31	3.00	0.75	1.25
3	8.25	1.25	5.00	4.62	8-0.88	6.62	3.57		3.60	3.50	1.81	3.25	1.81	0.38	3.63	0.81	1.38
3 1/2	9.00	1.38	5.50	5.25	8-1.00	7.25	4.07		4.10	4.00	1.94	3.38	1.94	0.38	4.13	1.56
4	10.00	1.38	6.19	5.75	8-1.00	7.88	4.57		4.60	4.50	2.00	3.50	2.00	0.44	4.63	1.44
5	11.00	1.50	7.31	7.00	8-1.00	9.25	5.66		5.69	5.56	2.12	4.00	2.12	0.44	5.69	1.69
6	12.50	1.62	8.50	8.12	12-1.00	10.62	6.72		6.75	6.63	2.25	4.06	2.25	0.50	6.75	1.81
8	15.00	1.88	10.62	10.25	12-1.12	13.00	8.72		8.75	8.63	2.69	4.62	2.69	0.50	8.75	2.00
10	17.50	2.12	12.75	12.62	16-1.25	15.25	10.88		10.92	10.75	2.88	4.88	4.00	0.50	10.88	2.19
12	20.50	2.25	15.00	14.75	16-1.38	17.75	12.88		12.92	12.75	3.12	5.38	4.25	0.50	12.94	2.38
14	23.00	2.38	16.25	16.75	20-1.38	20.25	14.14		14.18	14.00	3.31	5.88	4.62	0.50	14.19	2.50
16	25.50	2.50	18.50	19.00	20-1.50	22.50	16.16		16.19	16.00	3.69	6.00	5.00	0.50	16.19	2.69
18	28.00	2.62	21.00	21.00	24-1.50	24.75	18.18		18.20	18.00	3.88	6.50	5.38	0.50	18.19	2.75
20	30.50	2.75	23.00	23.12	24-1.62	27.00	20.20		20.25	20.00	4.00	6.62	5.75	0.50	20.19	2.88
22	33.00	2.88	25.25	25.25	24-1.75	29.25	22.22		22.25	22.00	4.25	6.75	6.00	0.50	--
24	36.00	3.00	27.25	27.62	24-1.88	32.00	24.25		24.25	24.00	4.50	6.88	6.25	0.50	24.19	3.25

To be specified by Purchaser.

DIMENSIONS ARE IN INCHES

(A) Bolt hole diameter 1/8" larger than bolt diameter

(B) See bore chart for wall thickness

(C) This dimension is commonly associated with "true" lap joints. Industry standard is to make to the slip on length through the hub.

ANSI B16.5 Class 600 Forged Flanges

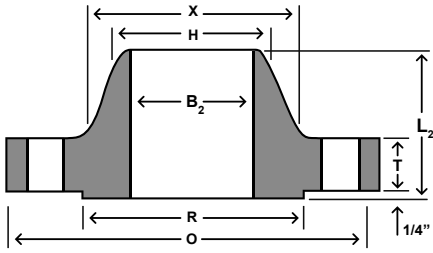

WELD NECK

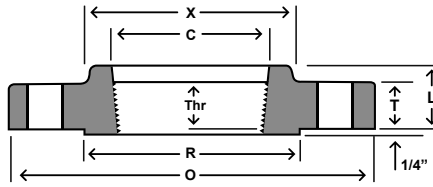

THREADED

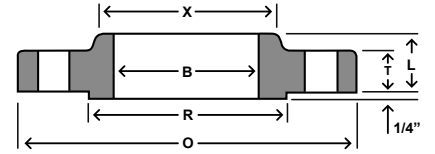

SLIP-ON

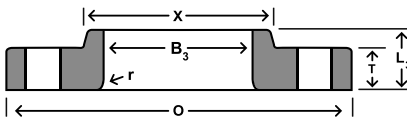

LAP JOINT

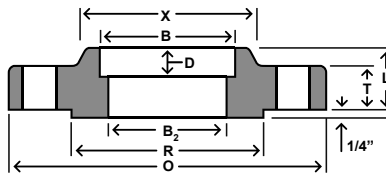

SOCKET WELD

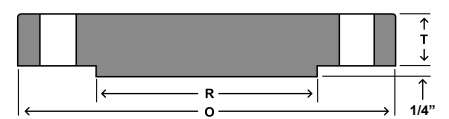

BLIND

Nom. Pipe Size	O	T	R	X	#/Dia of Holes ^a	Bolt Circle Dia	B	B ₂ ^b	B ₃	H	L	L ₂	L ₃ ^c	r	C	D	Thr
1/2	3.75	0.56	1.38	1.50	4-0.63	2.62	0.88		0.90	0.84	0.88	2.06	0.88	0.12	0.93	0.38	0.62
3/4	4.62	0.62	1.69	1.88	4-0.75	3.25	1.09		1.11	1.05	1.00	2.25	1.00	0.12	1.14	0.44	0.62
1	4.88	0.69	2.00	2.12	4-0.75	3.50	1.36		1.38	1.32	1.06	2.44	1.06	0.12	1.41	0.50	0.69
1 1/4	5.25	0.81	2.50	2.50	4-0.75	3.88	1.70		1.72	1.66	1.12	2.62	1.12	0.19	1.75	0.56	0.81
1 1/2	6.12	0.88	2.88	2.75	4-0.88	4.50	1.95		1.97	1.90	1.25	2.75	1.25	0.25	1.99	0.62	0.88
2	6.50	1.00	3.62	3.31	8-0.75	5.00	2.44		2.46	2.38	1.44	2.88	1.44	0.31	2.50	0.69	1.12
2 1/2	7.50	1.12	4.12	3.94	8-0.88	5.88	2.94		2.97	2.88	1.62	3.12	1.62	0.31	3.00	0.75	1.25
3	8.25	1.25	5.00	4.62	8-0.88	6.62	3.57		3.60	3.50	1.81	3.25	1.81	0.38	3.63	0.81	1.38
3 1/2	9.00	1.38	5.50	5.25	8-1.00	7.25	4.07		4.10	4.00	1.94	3.38	1.94	0.38	4.13	...	1.56
4	10.75	1.50	6.19	6.00	8-1.00	8.50	4.57		4.60	4.50	2.12	4.00	2.12	0.44	4.63	...	1.62
5	13.00	1.75	7.31	7.44	8-1.12	10.50	5.66		5.69	5.56	2.38	4.50	2.38	0.44	5.69	...	1.88
6	14.00	1.88	8.50	8.75	12-1.12	11.50	6.72		6.75	6.63	2.62	4.62	2.62	0.50	6.75	...	2.00
8	16.50	2.19	10.62	10.75	12-1.25	13.75	8.72		8.75	8.63	3.00	5.25	3.00	0.50	8.75	...	2.25
10	20.00	2.50	12.75	13.50	16-1.38	17.00	10.88		10.92	10.75	3.38	6.00	4.38	0.50	10.88	...	2.56
12	22.00	2.62	15.00	15.75	20-1.38	19.25	12.88		12.92	12.75	3.62	6.12	4.62	0.50	12.94	...	2.75
14	23.75	2.75	16.25	17.00	20-1.50	20.75	14.14		14.18	14.00	3.69	6.50	5.00	0.50	14.19	...	2.88
16	27.00	3.00	18.50	19.50	20-1.63	23.75	16.16		16.19	16.00	4.19	7.00	5.50	0.50	16.19	...	3.06
18	29.25	3.25	21.00	21.50	20-1.75	25.75	18.18		18.20	18.00	4.62	7.25	6.00	0.50	18.19	...	3.12
20	32.00	3.50	23.00	24.00	20-1.75	28.50	20.20		20.25	20.00	5.00	7.50	6.50	0.50	20.19	...	3.25
22	34.25	3.75	25.25	26.25	24-1.75	30.63	22.22		22.25	22.00	5.25	7.75	6.88	0.50
24	37.00	4.00	27.25	28.25	24-2.00	33.00	24.25		24.25	24.00	5.50	8.00	7.25	0.50	24.19	...	3.62

To be specified by Purchaser.

DIMENSIONS ARE IN INCHES

(A) Bolt hole diameter 1/8" larger than bolt diameter

(B) See bore chart for wall thickness

(C) This dimension is commonly associated with "true" lap joints. Industry standard is to make to the slip on length through the hub.

ANSI B16.5 Class 900 Forged Flanges

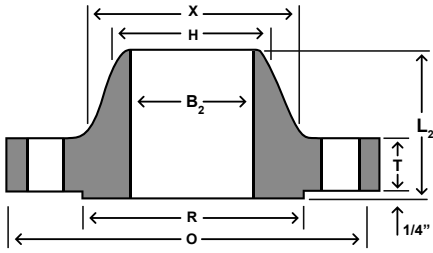

WELD NECK

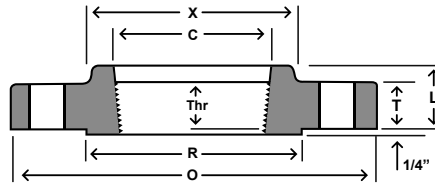

THREADED

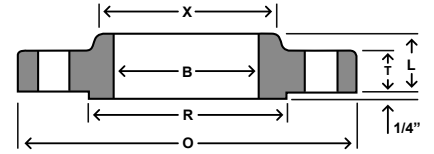

SLIP—ON

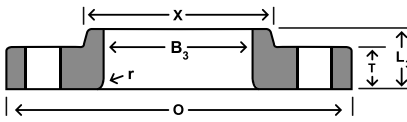

LAP JOINT



BLIND

Nom. Pipe Size	O	T	R	X	#/Dia of Holes ^a	Bolt Circle Dia	B	B ₂ ^b	B ₃	H	L	L ₂	L ₃ ^c	r	C	Thr
----------------	---	---	---	---	-----------------------------	-----------------	---	-----------------------------	----------------	---	---	----------------	-----------------------------	---	---	-----

Sizes 1/2" through 2 1/2" are identical to class 1500.

3	9.50	1.50	5.00	5.00	8-1.00	7.50	3.57									
4	11.50	1.75	6.19	6.25	8-1.25	9.25	4.57									
5	13.75	2.00	7.31	7.50	8-1.38	11.00	5.66									
6	15.00	2.19	8.50	9.25	12-1.25	12.50	6.72									
8	18.50	2.50	10.63	11.75	12-1.50	15.50	8.72									
10	21.50	2.75	12.75	14.50	16-1.50	18.50	10.88									
12	24.00	3.12	15.00	16.50	20-1.50	21.00	12.88									
14	25.25	3.38	16.25	17.75	20-1.63	22.00	14.14									
16	27.75	3.50	18.50	20.00	20-1.75	24.25	16.16									
18	31.00	4.00	21.00	22.25	20-2.00	27.00	18.18									
20	33.75	4.25	23.00	24.50	20-2.13	29.50	20.20									
24	41.00	5.50	27.25	29.50	20-2.63	35.50	24.25									

Sizes 1/2" through 2 1/2" are identical to class 1500.

	3.60	3.50	2.12	4.00	2.12	0.38	3.63	1.62								
	4.60	4.50	2.75	4.50	2.75	0.44	4.63	1.88								
	5.69	5.56	3.12	5.00	3.12	0.44	5.69	2.12								
	6.75	6.63	3.38	5.50	3.38	0.50	6.75	2.25								
	8.75	8.63	4.00	6.38	4.50	0.50	8.75	2.50								
	10.92	10.75	4.25	7.25	5.00	0.50	10.88	2.81								
	12.92	12.75	4.63	7.88	5.62	0.50	12.94	3.00								
	14.18	14.00	5.12	8.38	6.12	0.50	14.19	3.25								
	16.19	16.00	5.25	8.50	6.50	0.50	16.19	3.38								
	18.20	18.00	6.00	9.00	7.50	0.50	18.19	3.50								
	20.25	20.00	6.25	9.75	8.25	0.50	20.19	3.62								
	24.25	24.00	8.00	11.50	10.50	0.50	24.19	4.00								

To be specified by Purchaser.

DIMENSIONS ARE IN INCHES

(A) Bolt hole diameter 1/8" larger than bolt diameter

(B) See bore chart for wall thickness

(C) This dimension is commonly associated with "true" lap joints. Industry standard is to make to the slip on length through the hub.

ANSI B16.5 Class 1500 Forged Flanges

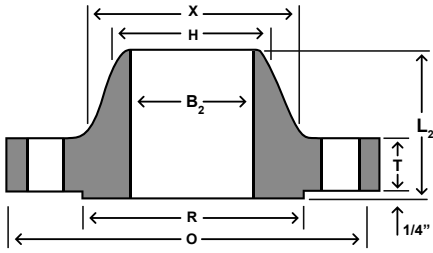

WELD NECK

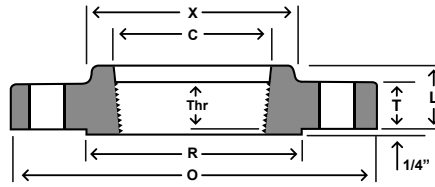

THREADED

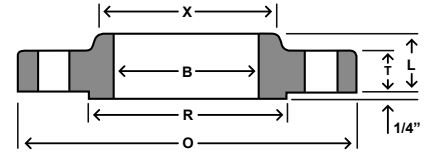

SLIP-ON

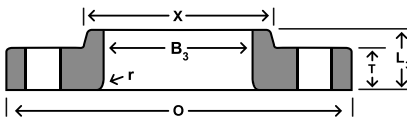

LAP JOINT

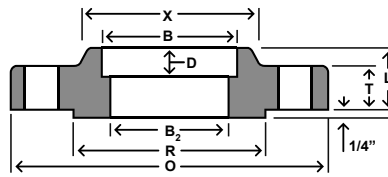

SOCKET WELD

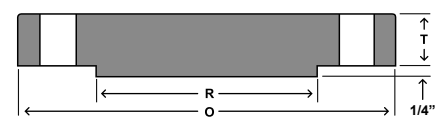

BLIND

Nom. Pipe Size	O	T	R	X	#/Dia of Holes ^a	Bolt Circle Dia	B	B ₂ ^b	B ₃	H	L	L ₂	L ₃ ^c	r	C	D	Thr
1/2	4.75	0.88	1.38	1.50	4-0.88	3.25	0.88		0.90	0.84	1.25	2.38	1.25	0.12	0.93	0.38	0.88
3/4	5.12	1.00	1.69	1.75	4-0.88	3.50	1.09		1.11	1.05	1.38	2.75	1.38	0.12	1.14	0.44	1.00
1	5.88	1.12	2.00	2.06	4-1.00	4.00	1.36		1.38	1.32	1.62	2.88	1.62	0.12	1.41	0.50	1.12
1 1/4	6.25	1.12	2.50	2.50	4-1.00	4.38	1.70		1.72	1.66	1.62	2.88	1.62	0.19	1.75	0.56	1.19
1 1/2	7.00	1.25	2.88	2.75	4-1.12	4.88	1.95		1.97	1.90	1.75	3.25	1.75	0.25	1.99	0.62	1.25
2	8.50	1.50	3.63	4.12	8-1.00	6.50	2.44		2.46	2.38	2.25	4.00	2.25	0.31	2.50	0.69	1.50
2 1/2	9.62	1.62	4.13	4.88	8-1.12	7.50	2.94		2.97	2.88	2.50	4.12	2.50	0.31	3.00	0.75	1.88
3	10.50	1.88	5.00	5.25	8-1.25	8.00		3.60	3.50	4.62	2.88	0.38
4	12.25	2.12	6.19	6.38	8-1.38	9.50		4.60	4.50	4.88	3.56	0.44
5	14.75	2.88	7.31	7.75	8-1.63	11.50		5.69	5.56	6.12	4.12	0.44
6	15.50	3.25	8.50	9.00	12-1.50	12.50		6.75	6.63	6.75	4.69	0.50
8	19.00	3.62	10.63	11.50	12-1.75	15.50		8.75	8.63	8.38	5.62	0.50
10	23.00	4.25	12.75	14.50	12-2.00	19.00		10.92	10.75	10.00	7.00	0.50
12	26.50	4.88	15.00	17.75	16-2.12	22.50		12.92	12.75	11.12	8.62	0.50
14	29.50	5.25	16.25	19.50	16-2.38	25.00		14.18	14.00	11.75	9.50	0.50
16	32.50	5.75	18.50	21.75	16-2.63	27.75		16.19	16.00	12.25	10.25	0.50
18	36.00	6.38	21.00	23.50	16-2.88	30.50		18.20	18.00	12.88	10.88	0.50
20	38.75	7.00	23.00	25.25	16-3.12	32.75		20.25	20.00	14.00	11.50	0.50
24	46.00	8.00	27.25	30.00	16-3.63	39.00		24.25	24.00	16.00	13.00	0.50

To be specified by Purchaser.

DIMENSIONS ARE IN INCHES

(A) Bolt hole diameter 1/8" larger than bolt diameter

(B) See bore chart for wall thickness

(C) This dimension is commonly associated with "true" lap joints. Industry standard is to make to the slip on length through the hub.

ANSI B16.5 Class 2500 Forged Flanges

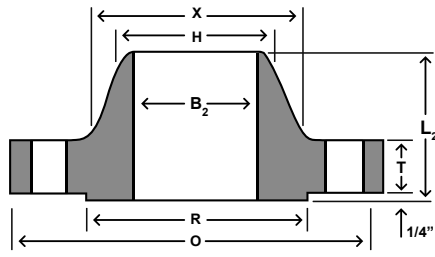

WELD NECK

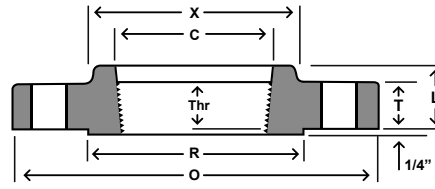

THREADED

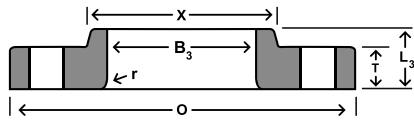

LAP JOINT

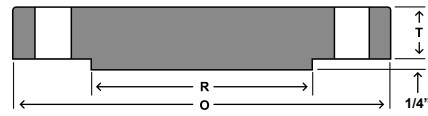

BLIND

Nom. Pipe Size	O	T	R	X	#/Dia of Holes ^a	Bolt Circle Dia	B ₂ ^b	B ₃	H	L	L ₂	L ₃	r	C	Thr
1/2	5.25	1.19	1.38	1.69	4-0.88	3.50		0.90	0.84	1.56	2.88	1.56	0.12	0.93	1.12
3/4	5.50	1.25	1.69	2.00	4-0.88	3.75		1.11	1.05	1.69	3.12	1.69	0.12	1.14	1.25
1	6.25	1.38	2.00	2.25	4-1.00	4.25		1.38	1.32	1.88	3.50	1.88	0.12	1.41	1.38
1 1/4	7.25	1.50	2.50	2.88	4-1.12	5.13		1.72	1.66	2.06	3.75	2.06	0.19	1.75	1.50
1 1/2	8.00	1.75	2.88	3.12	4-1.25	5.75		1.97	1.90	2.38	4.38	2.38	0.25	1.99	1.75
2	9.25	2.00	3.63	3.75	8-1.12	6.75		2.46	2.38	2.75	5.00	2.75	0.31	2.50	2.00
2 1/2	10.50	2.25	4.13	4.50	8-1.25	7.75		2.97	2.88	3.12	5.62	3.12	0.31	3.00	2.25
3	12.00	2.62	5.00	5.25	8-1.38	9.00		3.60	3.50	6.62	3.62	0.38
4	14.00	3.00	6.19	6.50	8-1.63	10.75		4.60	4.50	7.50	4.25	0.44
5	16.50	3.62	7.31	8.00	8-1.88	12.75		5.69	5.56	9.00	5.12	0.44
6	19.00	4.25	8.50	9.25	8-2.12	14.50		6.75	6.63	10.75	6.00	0.50
8	21.75	5.00	10.63	12.00	12-2.12	17.25		8.75	8.63	12.50	7.00	0.50
10	26.50	6.50	12.75	14.75	12-2.63	21.25		10.92	10.75	16.50	9.00	0.50
12	30.00	7.25	15.00	17.38	12-2.88	24.38		12.92	12.75	18.25	10.00	0.50

To be specified by Purchaser.

DIMENSIONS ARE IN INCHES

(A) Bolt hole diameter 1/8" larger than bolt diameter

(B) See bore chart for wall thickness

(C) This dimension is commonly associated with "true" lap joints. Industry standard is to make to the slip on length through the hub.